



PURCHASING DEPARTMENT

COLE COUNTY COMMISSION

311 East High Street, Room 200 | Jefferson City, MO 65101
Tel 573-634-9168 | Fax 573-634-8031
jprenger@colecouny.org

To: All Interested Parties
From: Jennifer Prenger, Cole County Purchasing Agent
Date: March 7, 2018
Re: Addendum One to Cole County Bid No. 2018-21: Flooring Replacement

The following information hereby becomes part of the above-referenced Request for Bid and shall be fully considered in the preparation of your response.

1. New transitions and door plates are to be included in the Scope of Work at both buildings.
2. At the Emergency Services Building, the removal and disposal of the existing carpet and the re-carpeting of the EMS dispatch office is hereby added to the Scope of Work as an option (please find amended Bidder Response Form attached). Carpet shall be new Mohawk Refined Look 878 Fine Line 24" x 24" carpet squares. Rubber baseboards do not need to be replaced as part of this work.

Due to the nature of the EMS service, dispatch capabilities must remain fully functional throughout this process; Contractors will be expected to work around and coordinate with EMS to accomplish this.

3. Q: At the Emergency Services Building, will the County be responsible for the removal/reinstallation of the toilets to accommodate flooring installation or will this be expected of the Contractor?
A: This will be the responsibility of the County.
4. Q: Will the removal/reinstallation of the cabinets in the "Meeting Room" at the Emergency Services Building be the responsibility the Contractor?
A: This will be the responsibility of the County.
5. Q: Is it possible to provide plans of the (future) Health Department that indicate specifically in which rooms you (a) would like carpet as an option and (b) will not require new 6" rubber baseboards?
A: Yes, please see attached Exhibit A.
6. Q: Do the rubber baseboards under the existing cabinetry at the (future) Health Department need to be replaced?
A: Yes, they are to be replaced if/where they are currently in place. It is acceptable for Contractors to either cut down 6" rubber baseboards or use 4".
7. Q: Is it possible to move the bid opening out by one week?
A: Yes, the bid opening is hereby moved to 3:30 p.m. on March 22, 2018.

8. Q: Are any/all of the built-in cabinets to remain at the (future) Health Department?

A: Please assume that ALL built-in cabinets will remain in the facility.

The bid receipt date and time HAVE BEEN CHANGED; submissions will be received until Thursday, March 22 at 3:30 p.m. The deadline for questions is Thursday, March 15.

I/We have received Addendum Number One to Bid No. 2018-21 and have fully considered the information provided in preparing a response.

Name of Company

Agent and Title

Authorized Signature

BID NUMBER 2018-21
BIDDER RESPONSE FORM (REVISED PER ADDENDUM ONE)

The undersigned agrees to enter into a contract with Cole County to provide work and services for each project priced INDEPENDENTLY of one another for costs as follow:

▪ **PROJECT ONE: EMERGENCY SERVICES BUILDING (APPROXIMATELY 4,000 SQ FT).**
**to include one (1) extra box of carpet*

\$ _____

▪ **PROJECT ONE: EMERGENCY SERVICES BUILDING (APPROXIMATELY 4,000 SQ FT) WITH PROPOSED ALTERNATE TO THE 20 MIL, COMMERCIAL RATED VINYL PLANK:**
**to include one (1) extra box of carpet*

PROPOSED ALT: _____ \$ _____

▪ **PROJECT TWO: HEALTH DEPARTMENT (APPROXIMATELY 17,000 SQ FT).**

OPTION A: With Carpeted Offices \$ _____
**to include six (6) extra boxes of carpet*

OPTION B: With Vinyl Plank Offices \$ _____

OPTION C: With Alternate to Vinyl Plank with Carpeted Offices \$ _____

OPTION D: With Alternate to Vinyl Plank Throughout \$ _____

PROPOSED ALT: _____

The undersigned agrees to enter into a contract with Cole County to provide ALL WORK AND SERVICES for both projects described for a TOTAL COST of:

PROJECT ONE AND PROJECT TWO, OPTION A \$ _____

PROJECT ONE ALTERNATE AND PROJECT TWO, OPTION A \$ _____

PROJECT ONE AND PROJECT TWO, OPTION B \$ _____

PROJECT ONE ALTERNATE AND PROJECT TWO, OPTION B \$ _____

PROJECT ONE AND PROJECT TWO, OPTION C \$ _____

PROJECT ONE ALTERNATE AND PROJECT TWO, OPTION C \$ _____

PROJECT ONE AND PROJECT TWO, OPTION D \$ _____

PROJECT ONE ALTERNATE AND PROJECT TWO, OPTION D \$ _____

▪ **PROJECT THREE: EMS DISPATCH**

\$ _____

PROPOSED TIMEFRAME.

Working days required for Project One: _____ days

Working days required for Project Two, Option A: _____ days

Working days required for Project Two, Option B: _____ days

Working days required for Project Three: _____ days

Availability to begin work (County anticipates mid-August commencement): _____



Statement of warranty for all products proposed as well as a statement of warranty for overall workmanship:

Name of Company

Authorized Signature

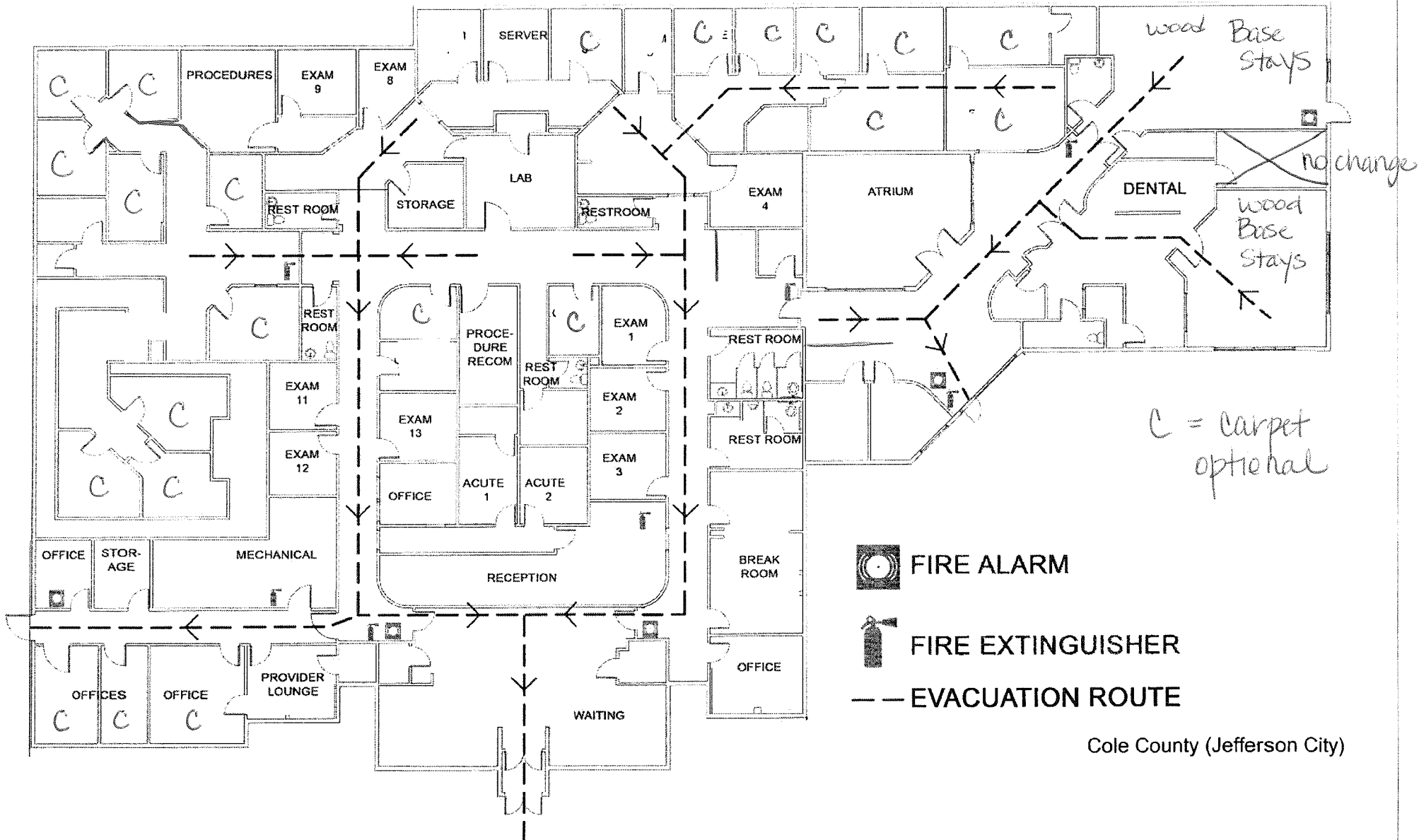
EXHIBIT A



-  FIRE ALARM
-  FIRE EXTINGUISHER
-  EVACUATION ROUTE

Cole County (Jefferson City)